

# **Neptune Midsleeper**

## **Assembly Instructions**

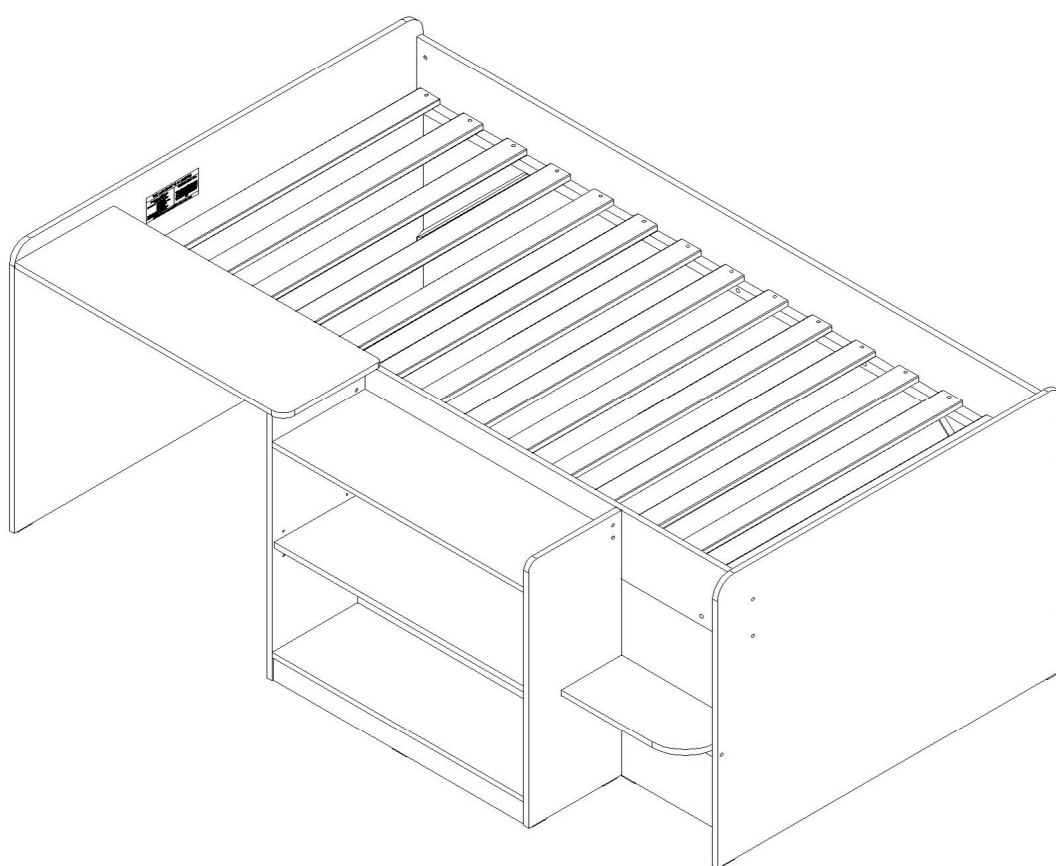

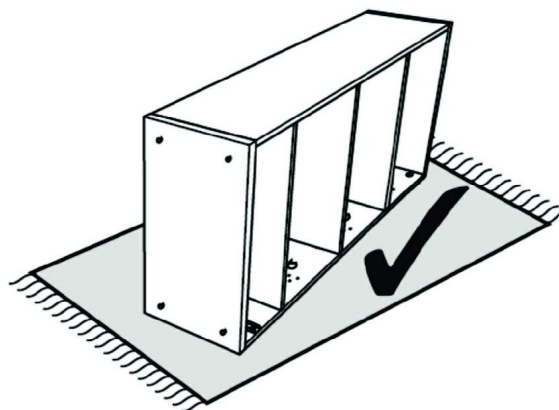
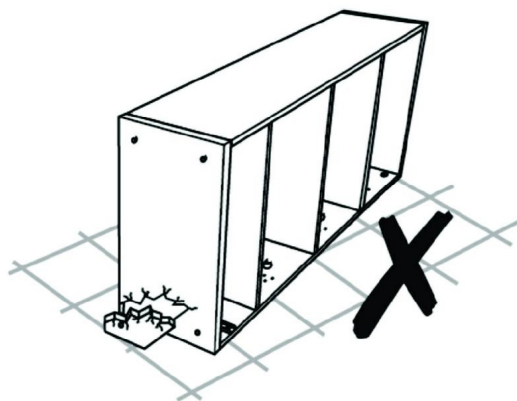
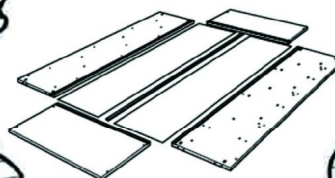
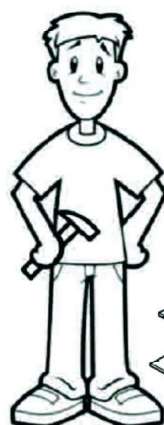
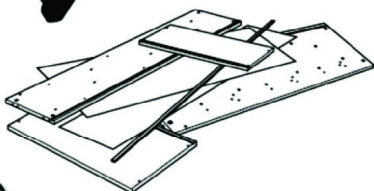
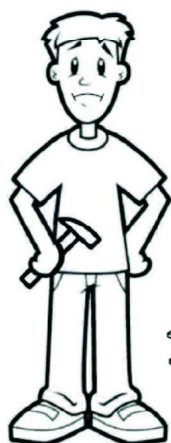
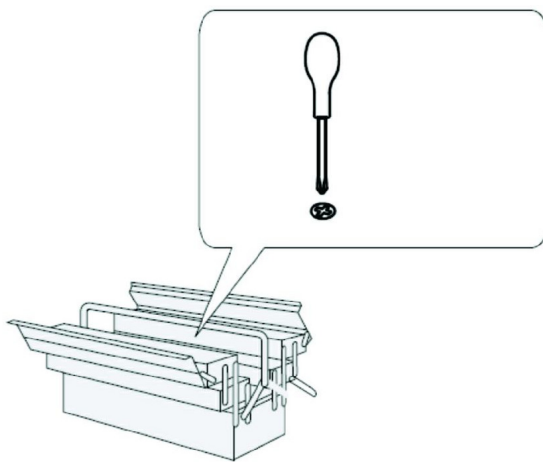
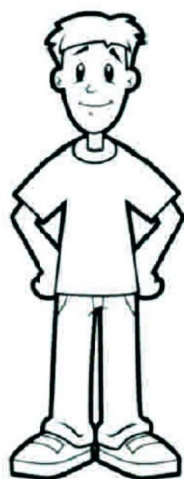

**Customer Service**  
**(01623 727374)**

# HARDWARE

A

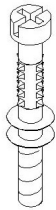

Cam Stud  
19PCS

B

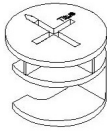

Cam  
19PCS

C



M8 x 25mm  
34PCS

D



Shelf Support  
4PCS

E

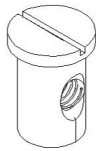

M6 Round Nut  
12PCS

F

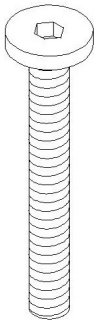

M6 x 50mm  
14PCS

G

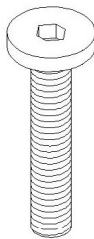

M6 x 35mm  
10PCS

H

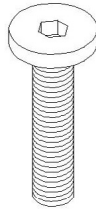

M6 x 30mm  
30PCS

J

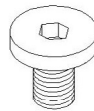

M6 x 12mm  
4PCS

K

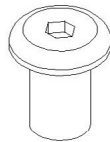

M6  
8PCS

L

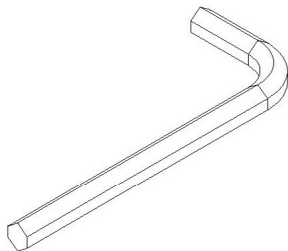

M4  
2PCS

M

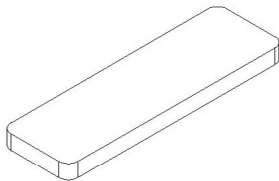

Felt Pads  
12PCS

# PARTS

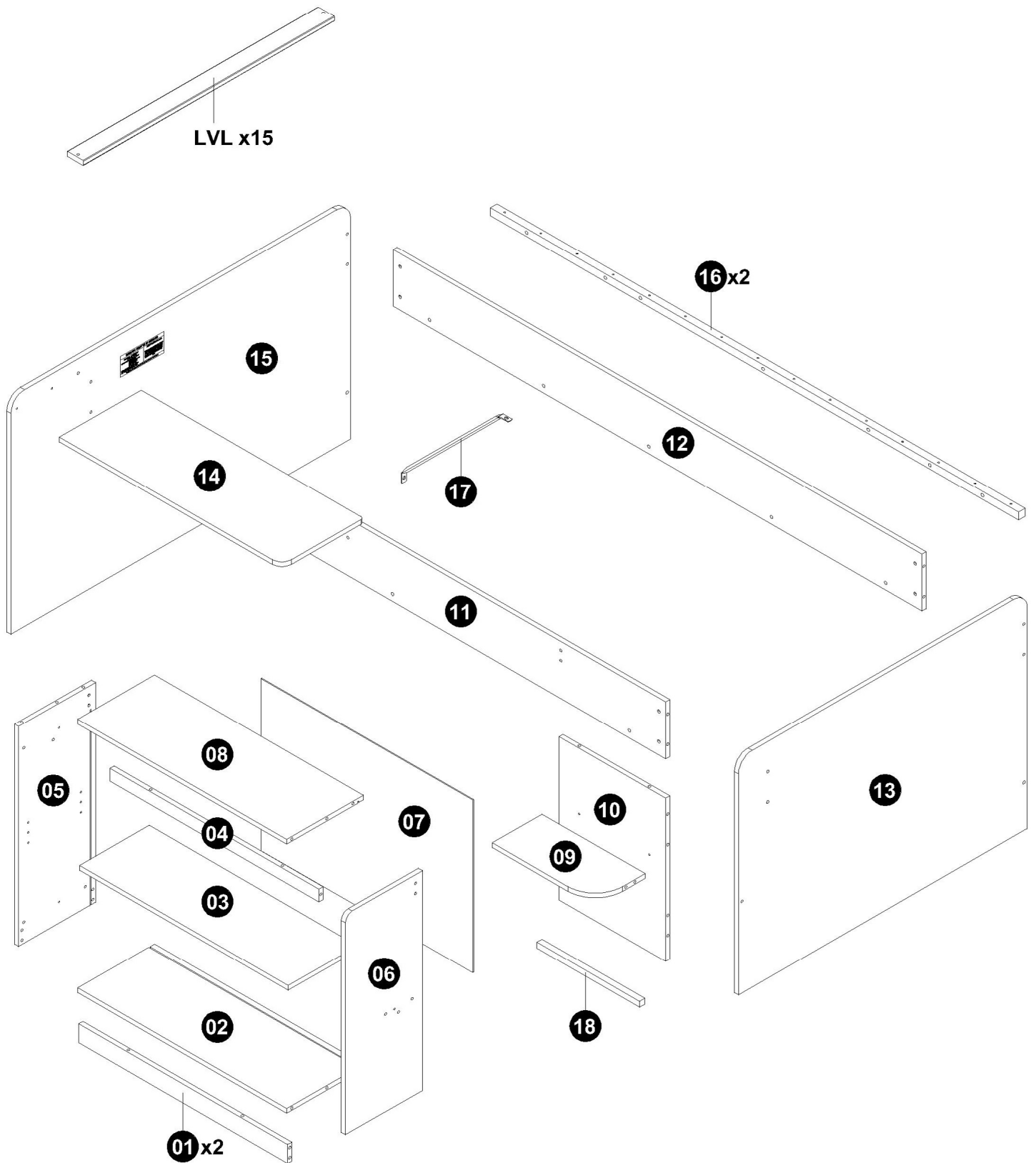



## IMPORTANT INFORMATION

**WARNING:** This bed is not suitable for children under 4 years.

**WARNING:** Do not place this child's bed near heat sources, windows and other furniture.

**WARNING:** Do not use this Child's Bed if any part is broken, torn or missing.

It is recommended that you always follow the manufacturer's instructions to assemble this product.

This product is intended for use by children over 4 years of age.

Children are likely to play, bounce, jump and climb on beds, therefore the child's bed should not be placed too close to other furniture or windows, blind cords, curtain pulls or other strings or cords and should be placed either tight to the wall or have a gap of 300mm between the wall and side of bed.

This bed may be dismantled for storage or transportation but checks must be made to ensure parts are not damaged before re-assembling. Replacement parts can be obtained from Julian Bowen Limited where available and at an additional cost.

**Recommended Mattress Size:** 90cm x 190cm (UK Single) with a depth of no more than 23cm.

It is necessary to frequently ventilate the room in order to keep the humidity low and to prevent mould in and around the bed.

Please periodically check all the fixings of the item and re-tighten when necessary.

This item conforms to British Safety Standards – BS8509:2008 + A1:2011

THIS LABEL IS NOT TO BE REMOVED	
<b>Neptune Midsleeper</b> Product Code - NEP 001 Distributed by: Julian Bowen Limited Bentnick House, Park Lane Business Park, Kirkby-in-Ashfield, Notts, NG17 9LE Factory ID: Manufactured in Malaysia Date of Manufacture: January 2020	<b>CERTIFICATION LABEL</b>  This bunk bed model has been tested by an independent laboratory and is in compliance with EN 747-1:2012 + A1:2015 - Standard Consumer Safety Specification For Bunk Beds & High Beds
<b>WARNING:</b> This upper bed is not suitable for children under six years	

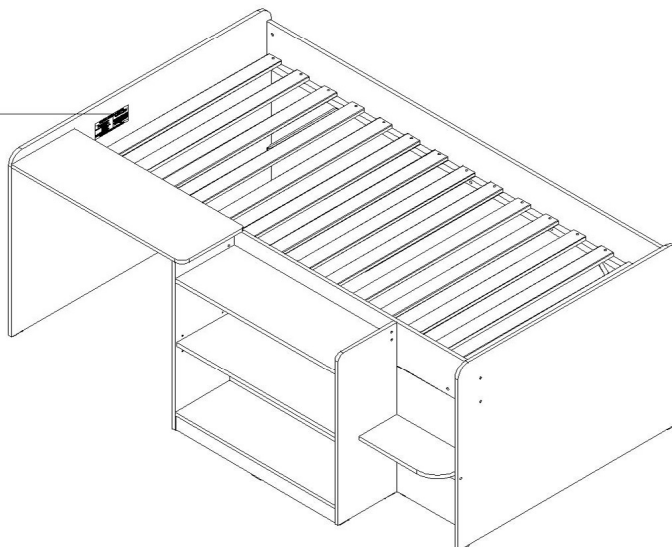

# Safety Advice

Please take the time to carefully read through the whole of these instructions before you commence.

Keep these instructions for future reference.

Unpack, inspect and check off all of the contents.

Please dispose of all packaging safely.

Small component parts could choke a child if swallowed.

We strongly recommend that you keep children well away from the work area.

It would be sensible to lay a sheet or blanket on the floor where you intend to work to avoid scratching this product and to protect your floor.

This product is heavy. Take extreme care when lifting to avoid personal injury or damage to the product.

Assemble the product as close to its intended final position in the room as possible.

**HANDY HINT:** If you keep the hardware in a bowl during assembly you will be less likely to lose them.

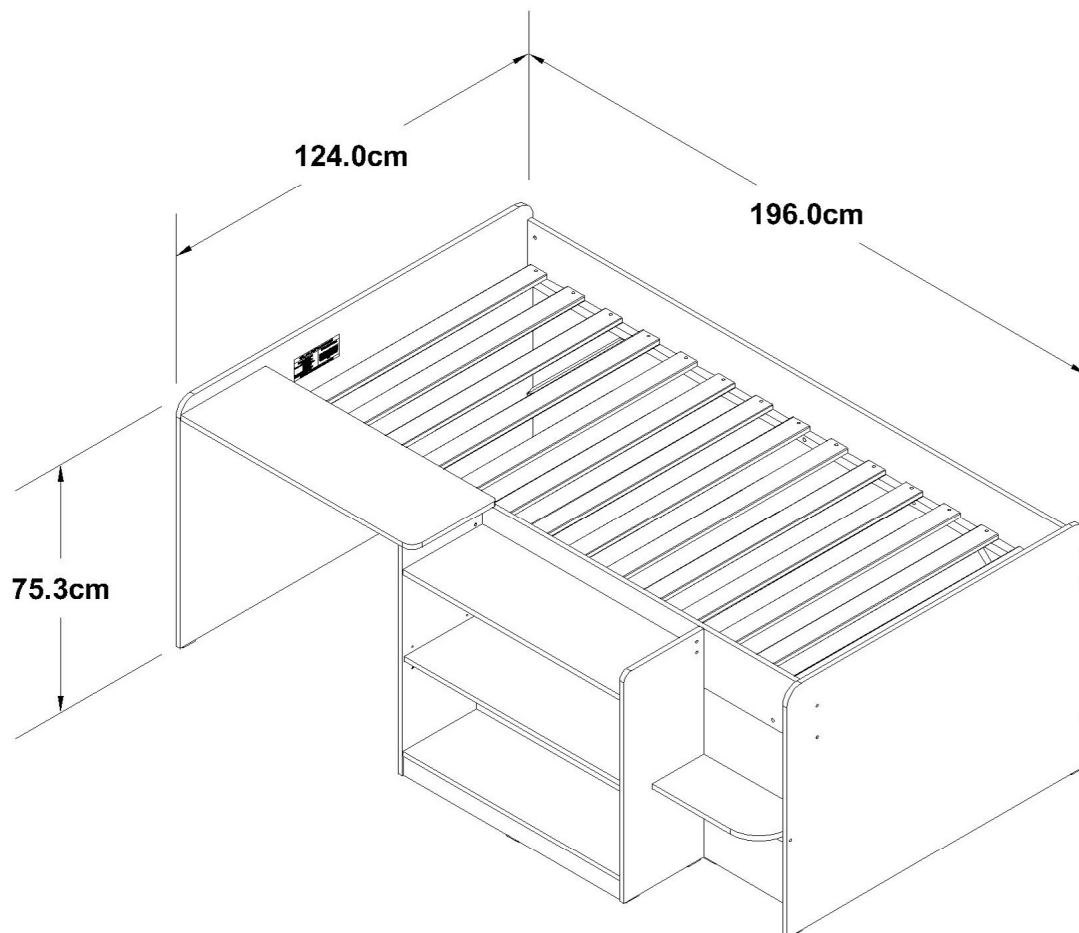

1

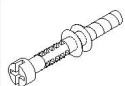

A x 7



B x 9

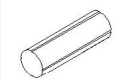

C x 29

01 x 2

02

04

06

05

09

08

10

**WHEN FITTING CAMS**

ENSURE STARTING POSITION IS CORRECT  
BEFORE YOU INSERT CONNECTING BOLT  
TURN CLOCKWISE UNTIL SECURE



CORRECT

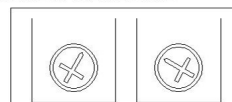

WRONG



D

A

2

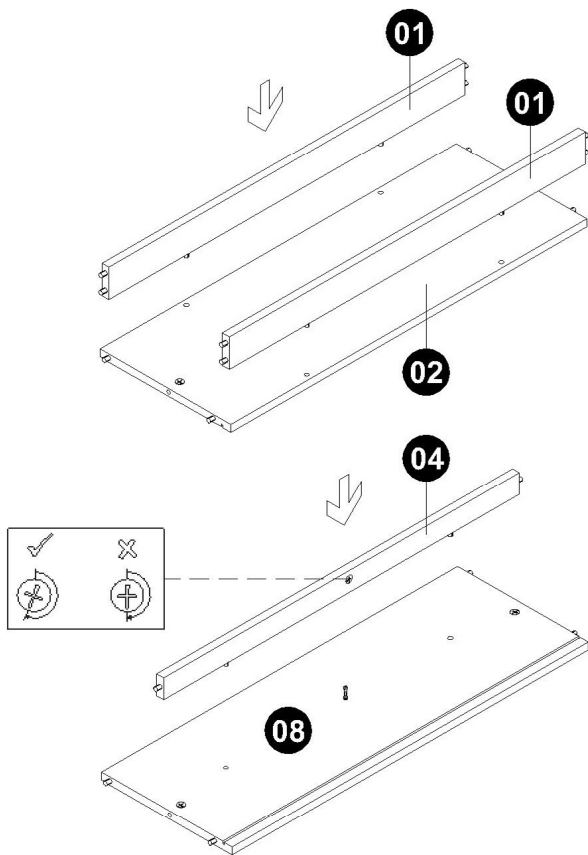

3

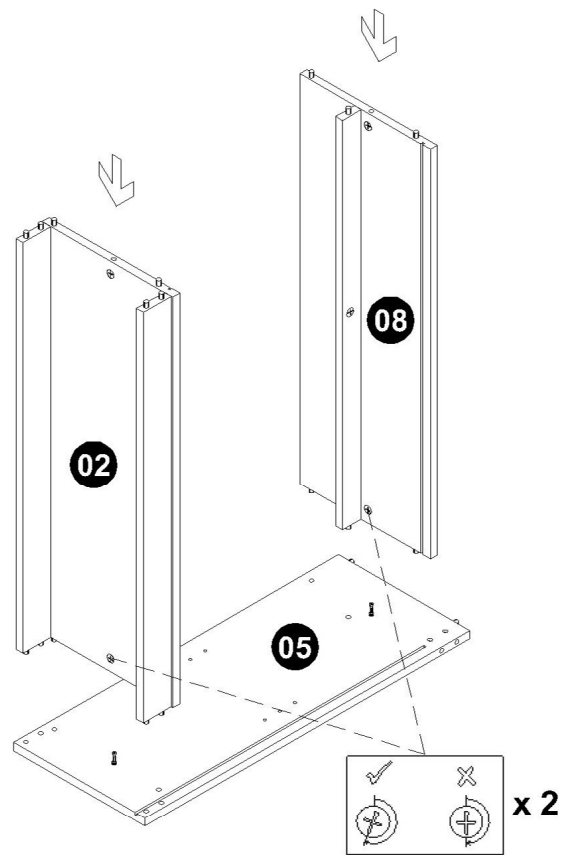

4

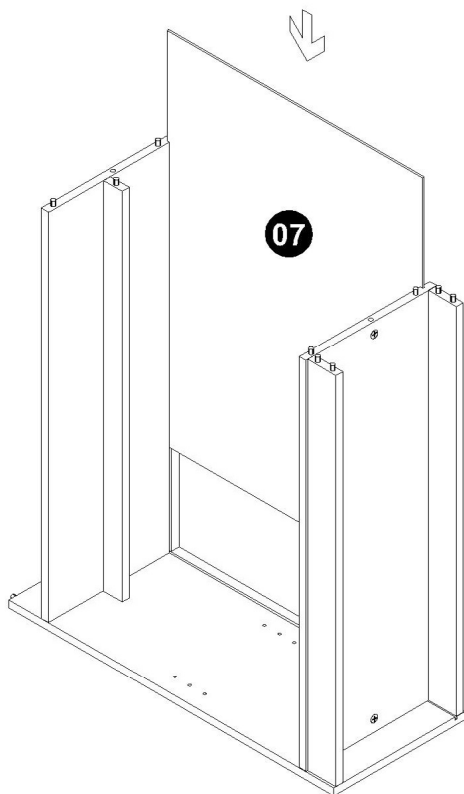

5

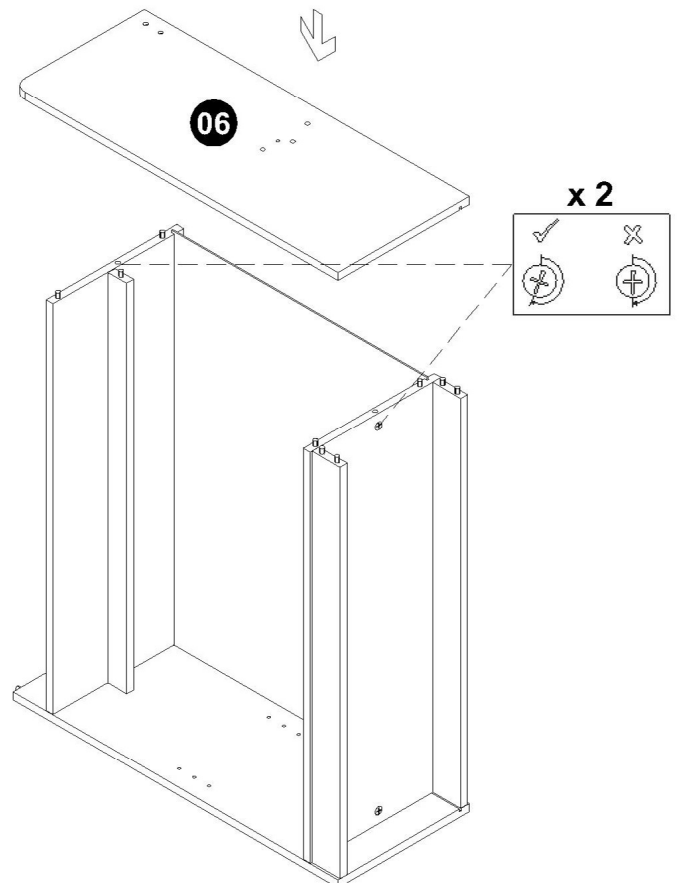

6



M x 6

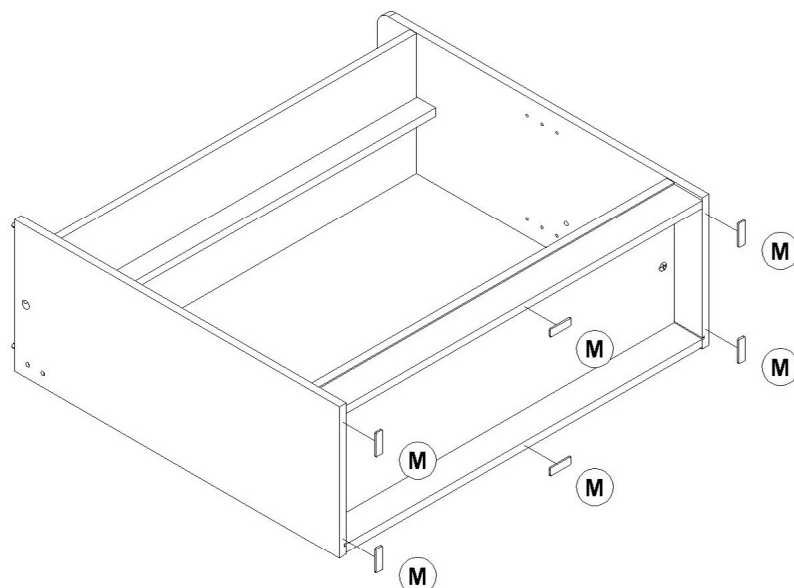

7



D x 2

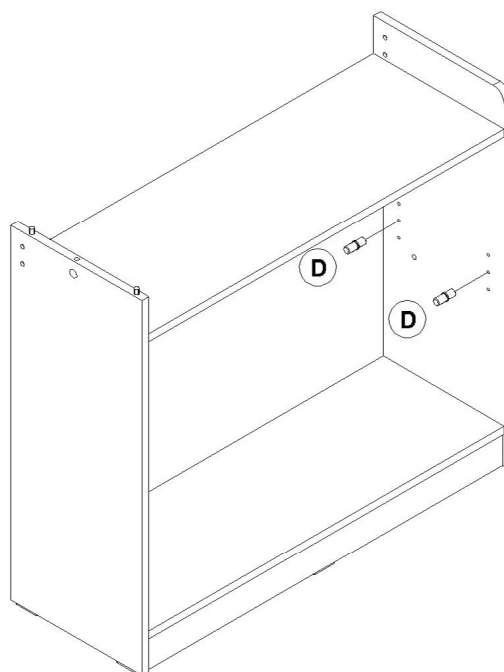

8

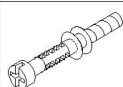

A x 1



D x 2

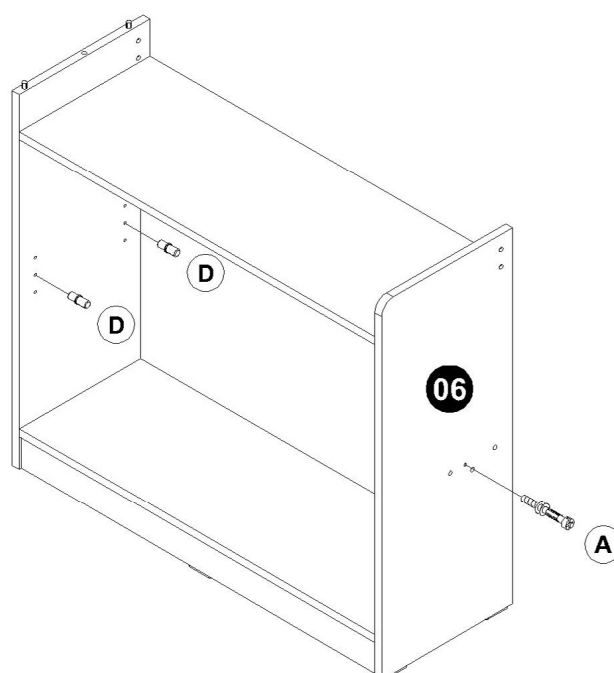

9



M x 2

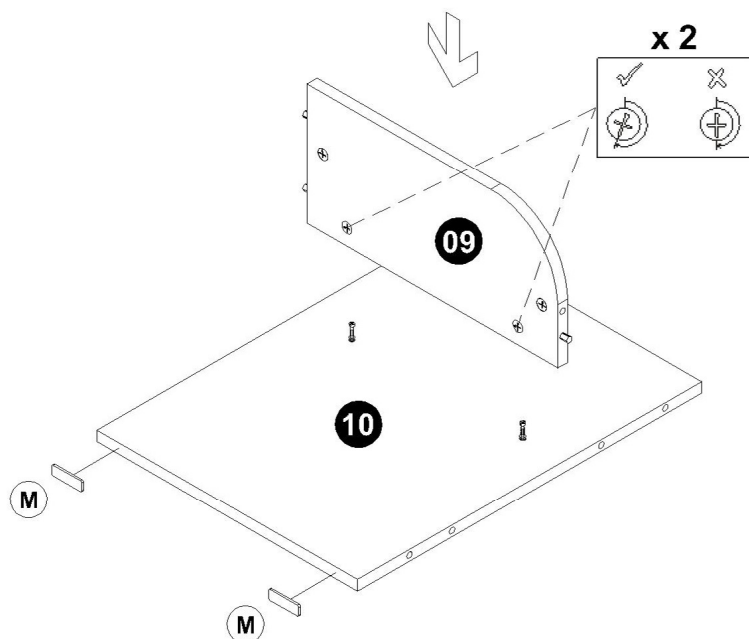

10

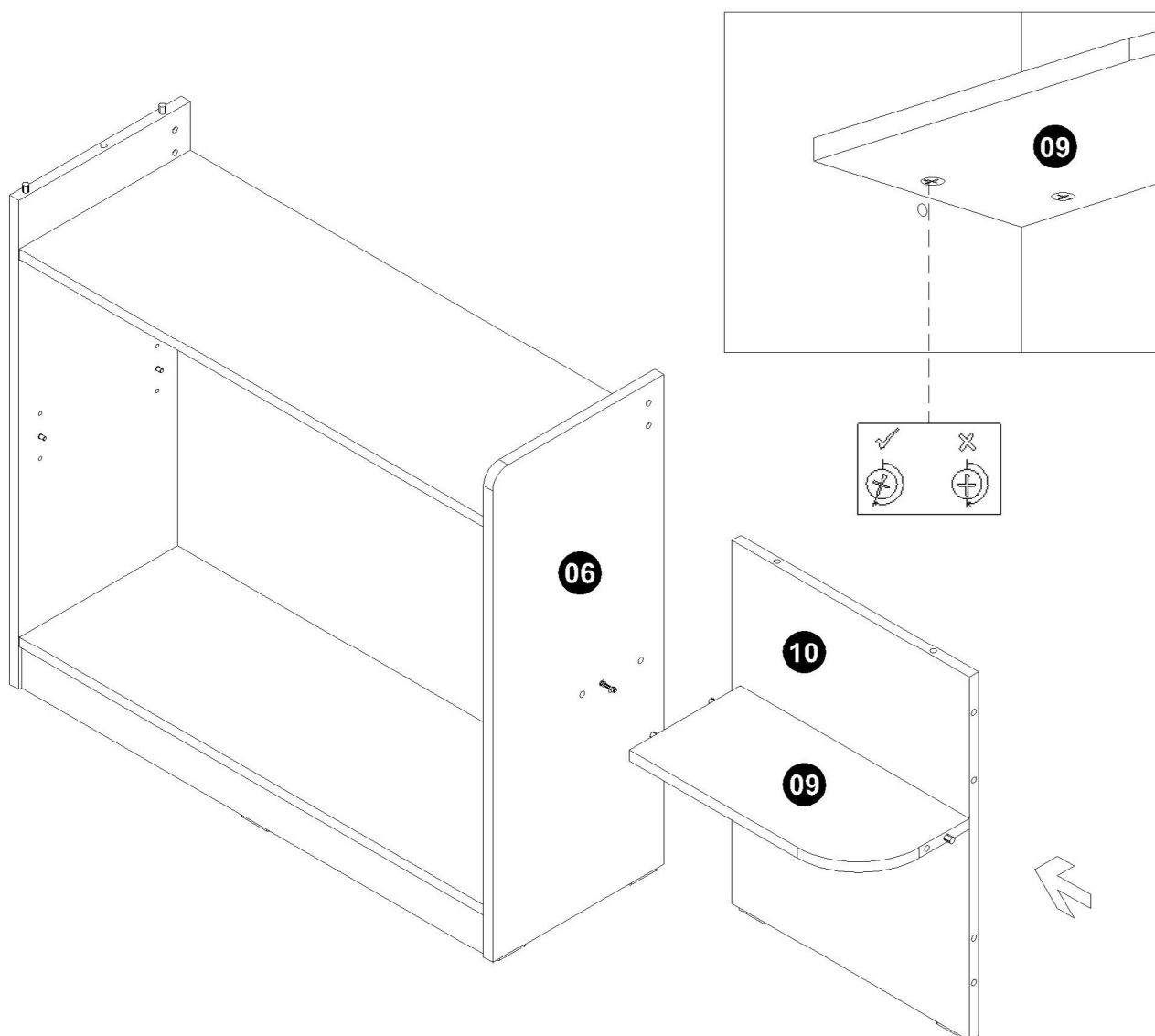

11



B x 4

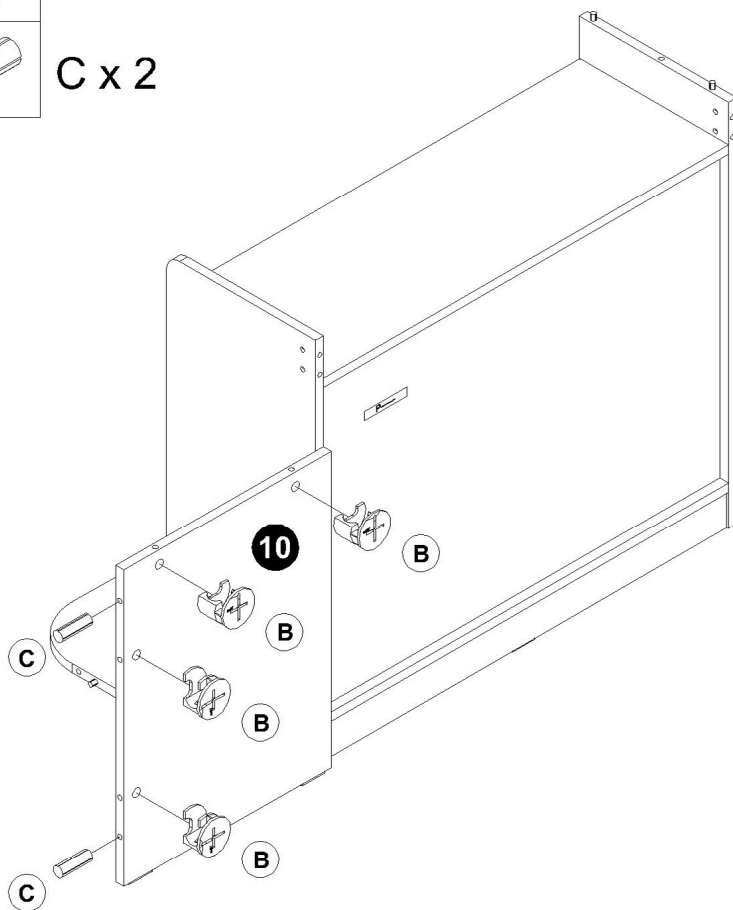

C x 2

**WHEN FITTING CAMS**

ENSURE STARTING POSITION IS CORRECT  
BEFORE YOU INSERT CONNECTING BOLT  
TURN CLOCKWISE UNTIL SECURE



↑  
CORRECT

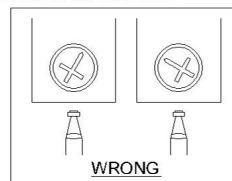

WRONG



12

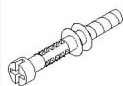

A x 3



M x 2

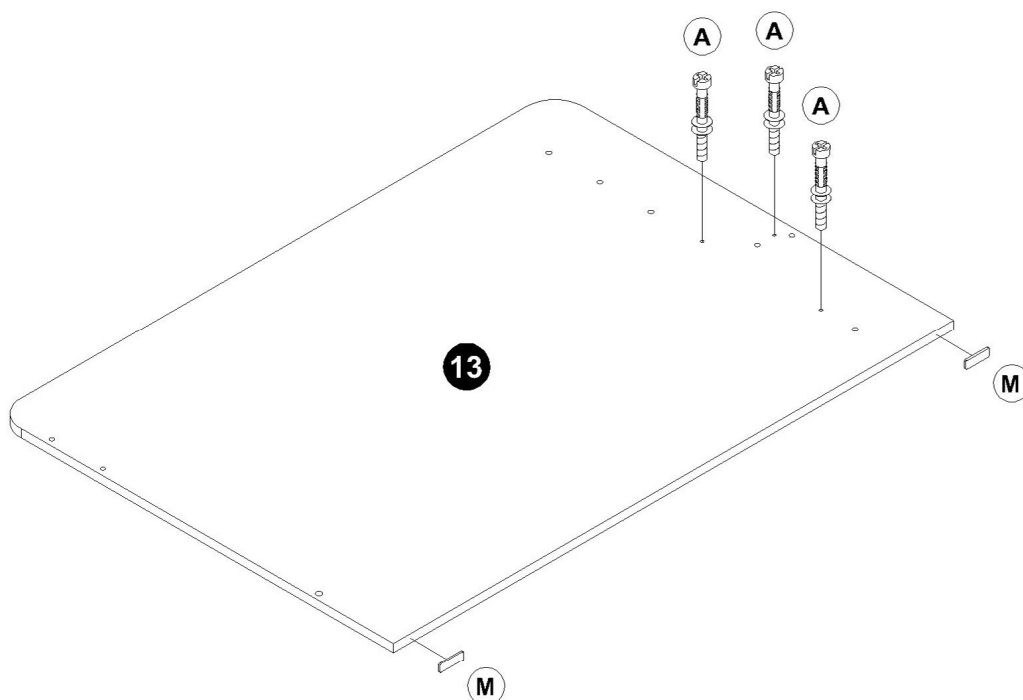

13

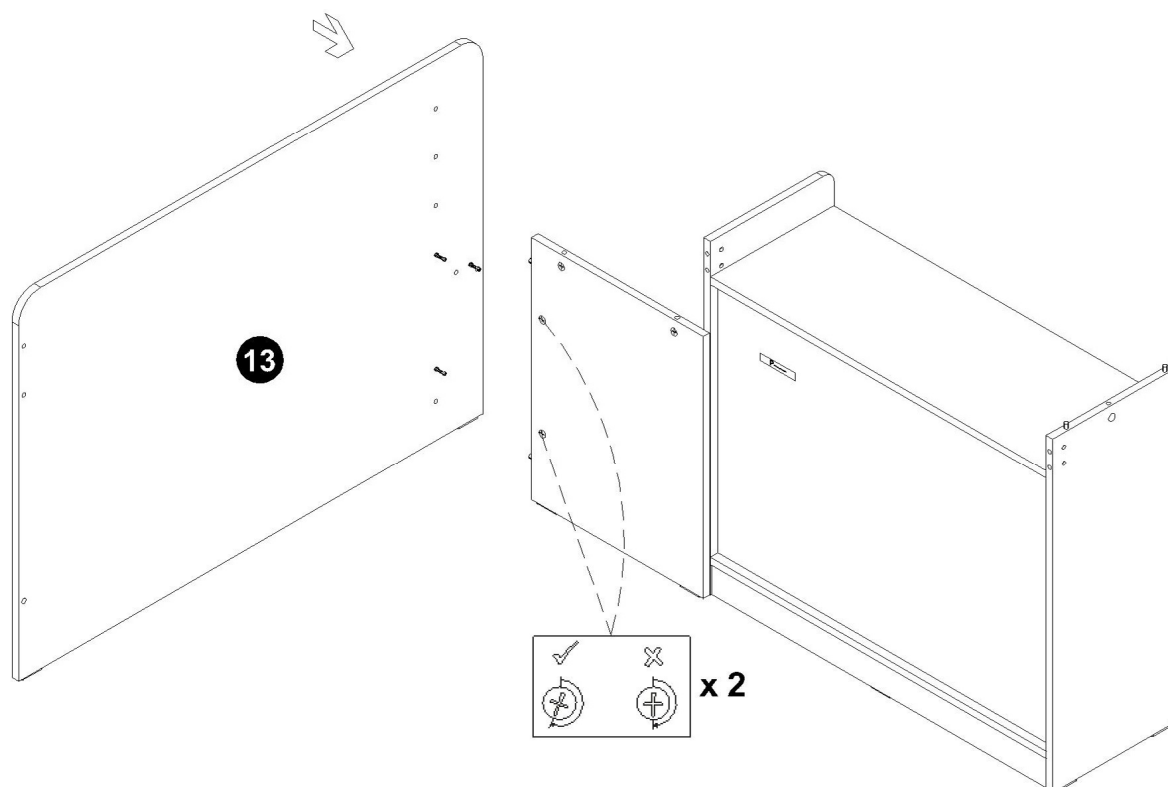

14

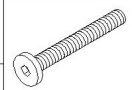

F x 2

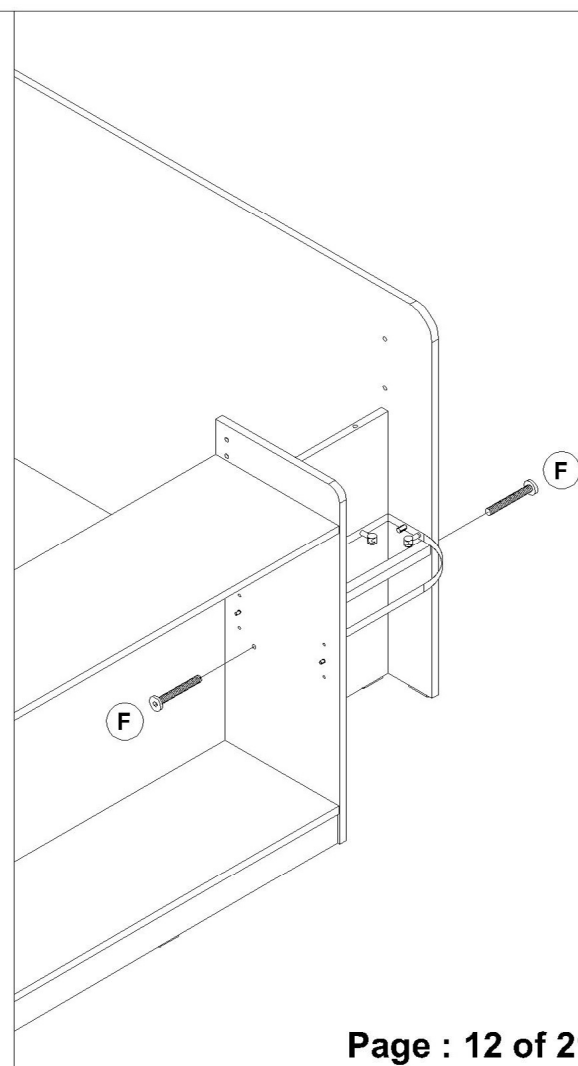
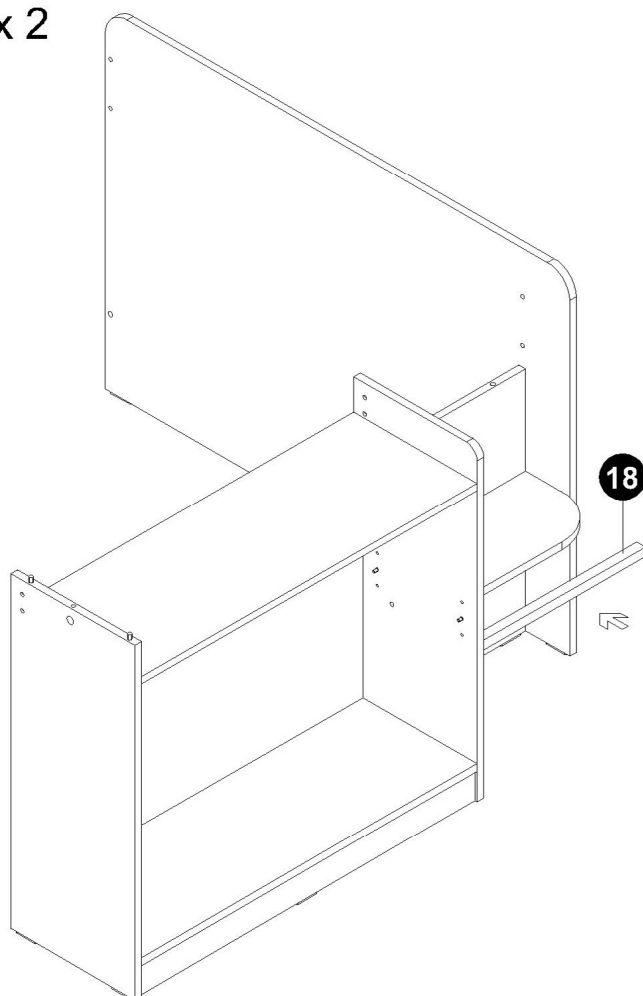



15



G x 4

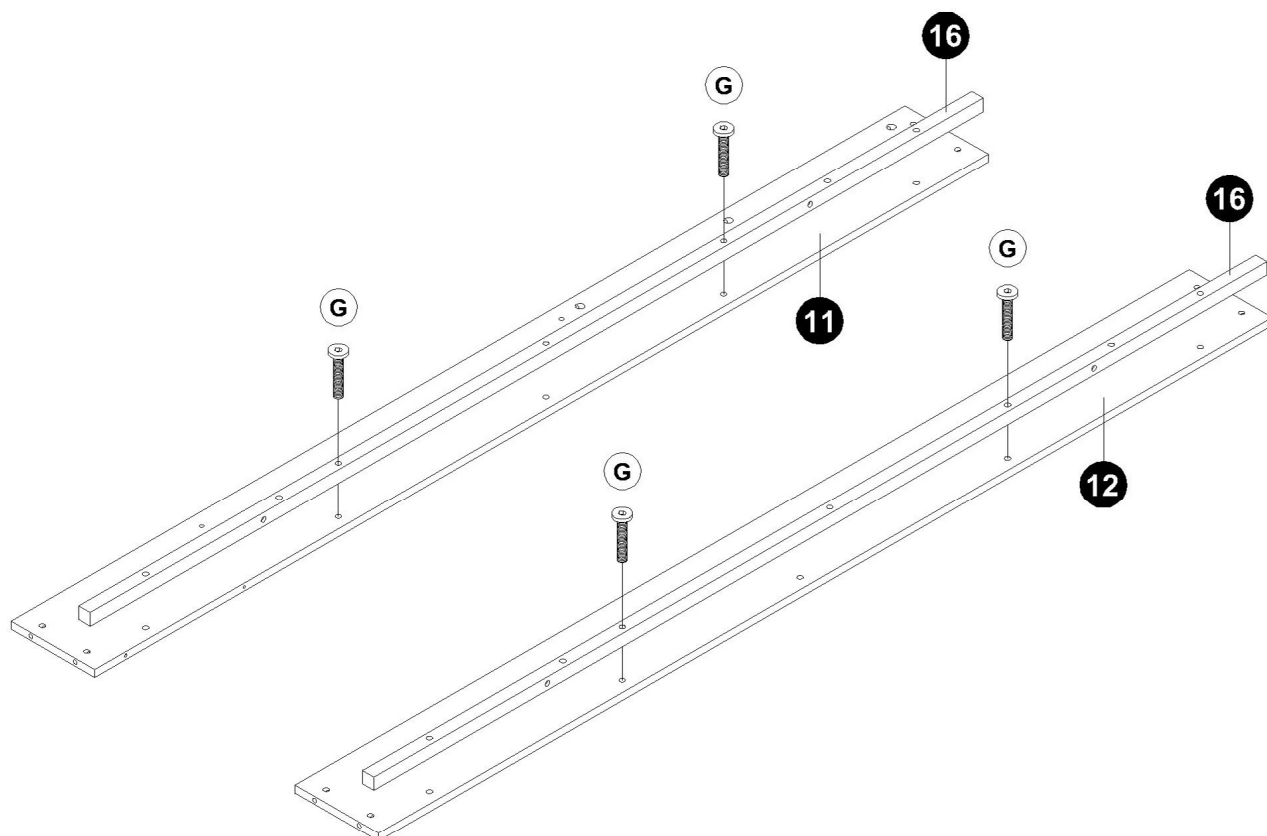

16



G x 6



K x 6

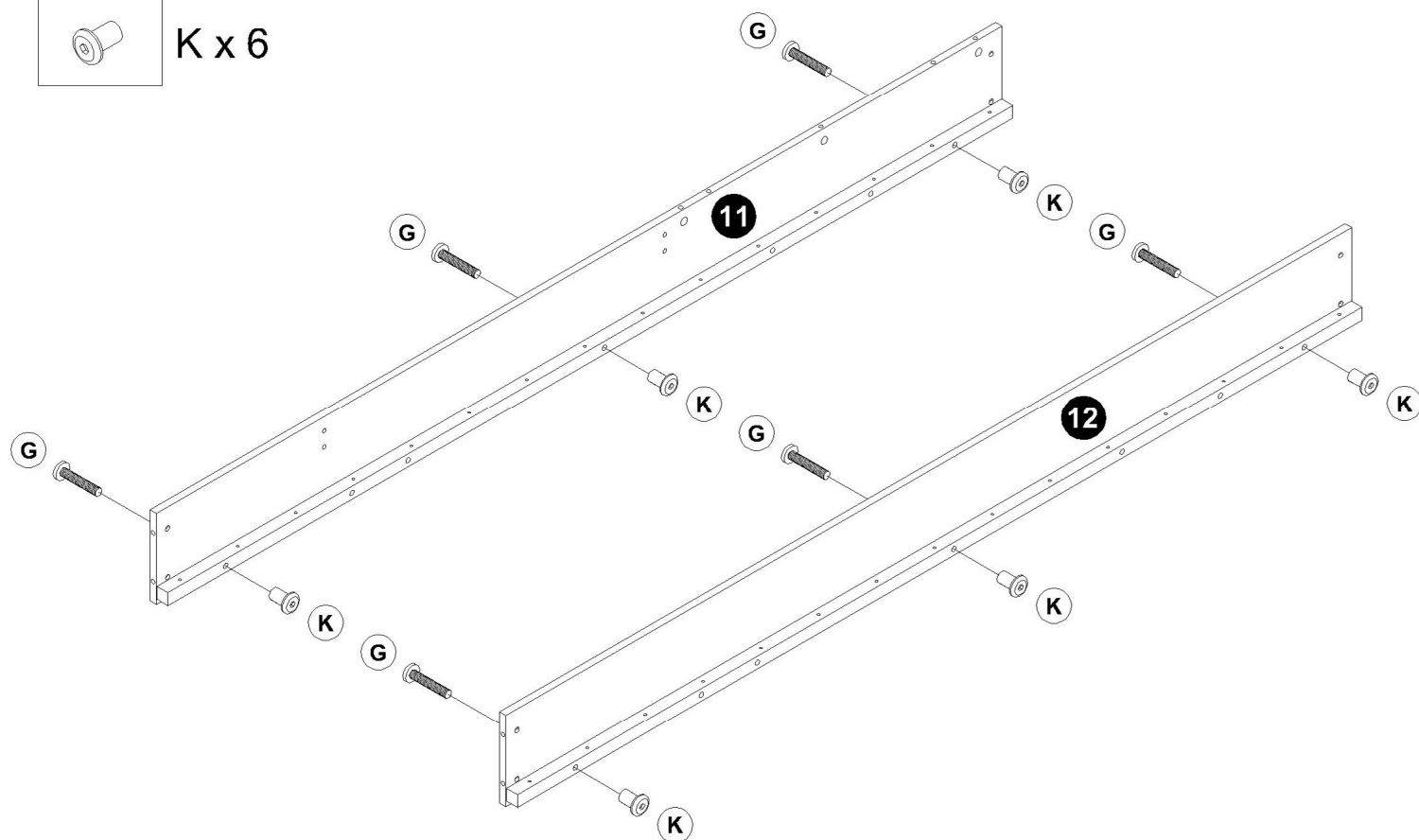

17

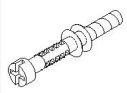

A x 2

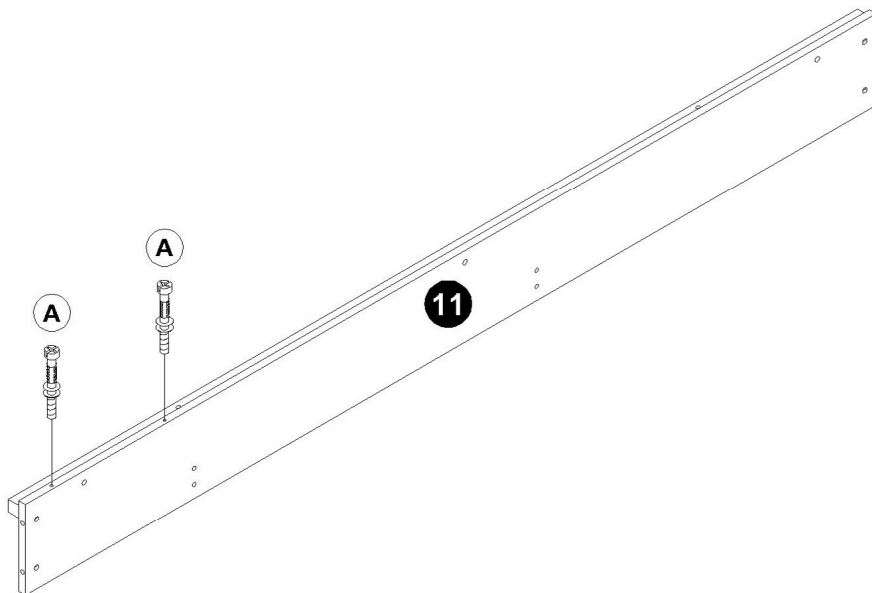

18

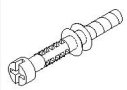

A x 6



B x 5

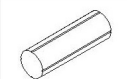

C x 3



M x 2

**WHEN FITTING CAMS**

ENSURE STARTING POSITION IS CORRECT  
BEFORE YOU INSERT CONNECTING BOLT  
TURN CLOCKWISE UNTIL SECURE

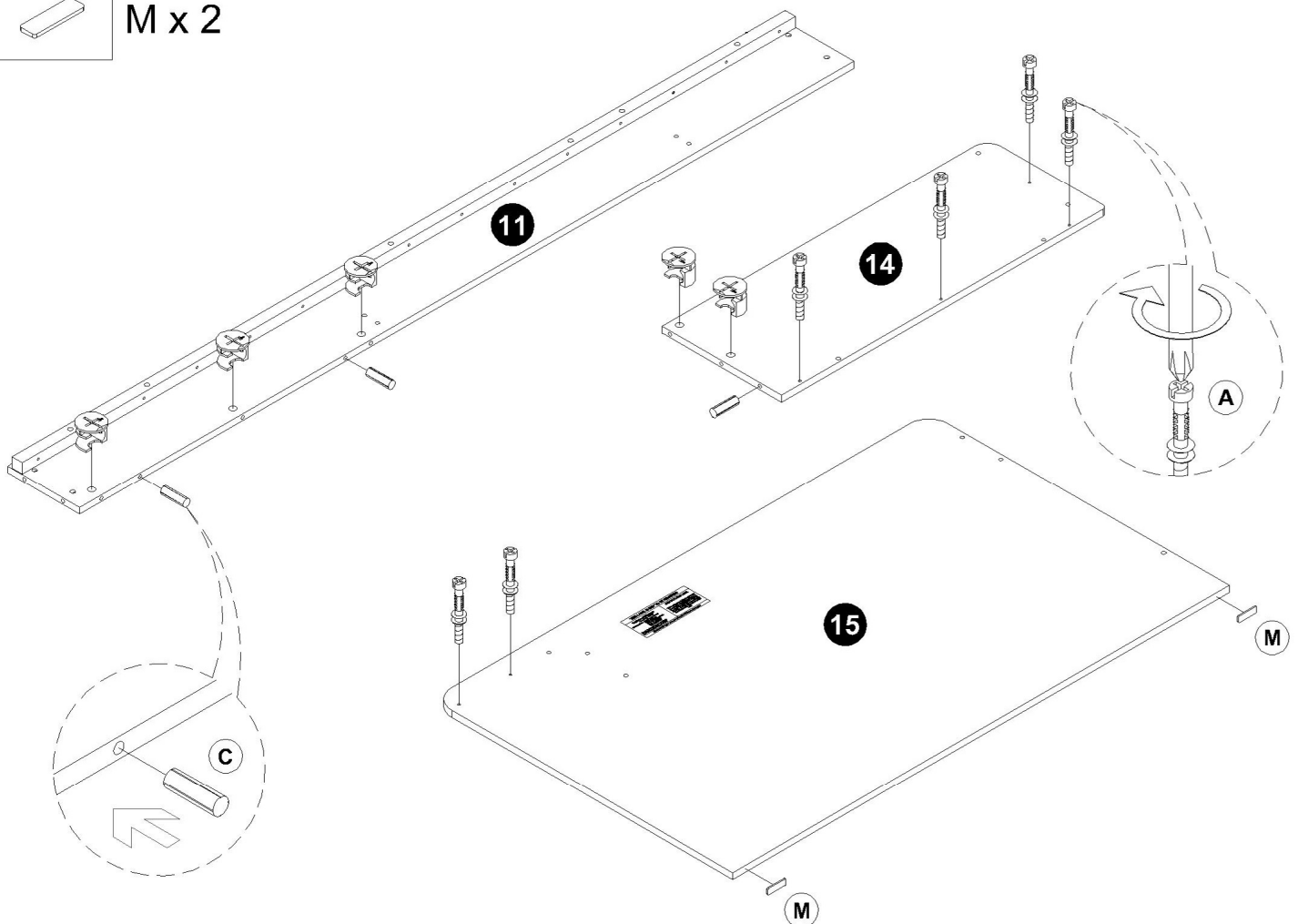
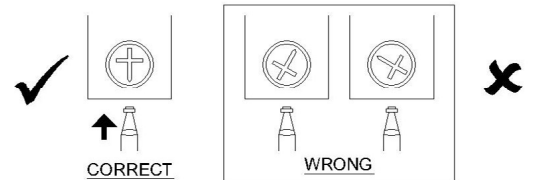

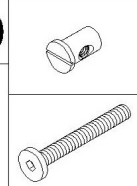
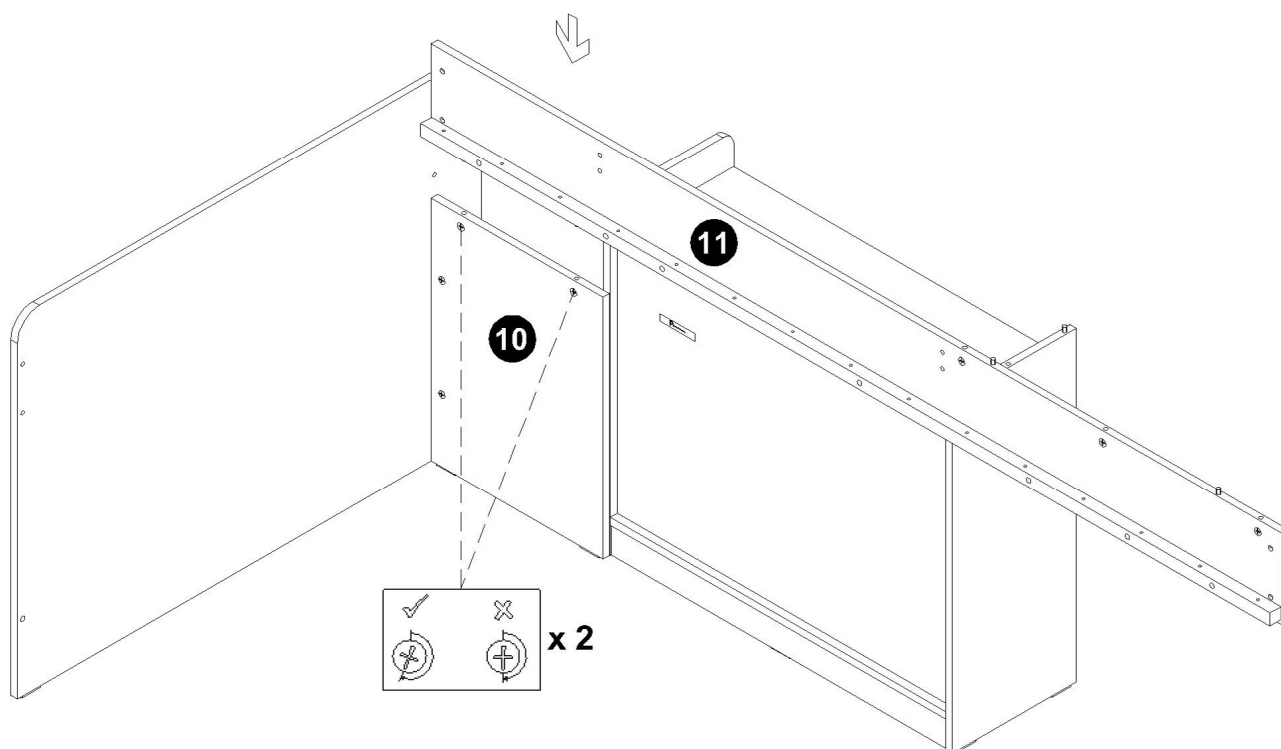

E x 6

F x 6

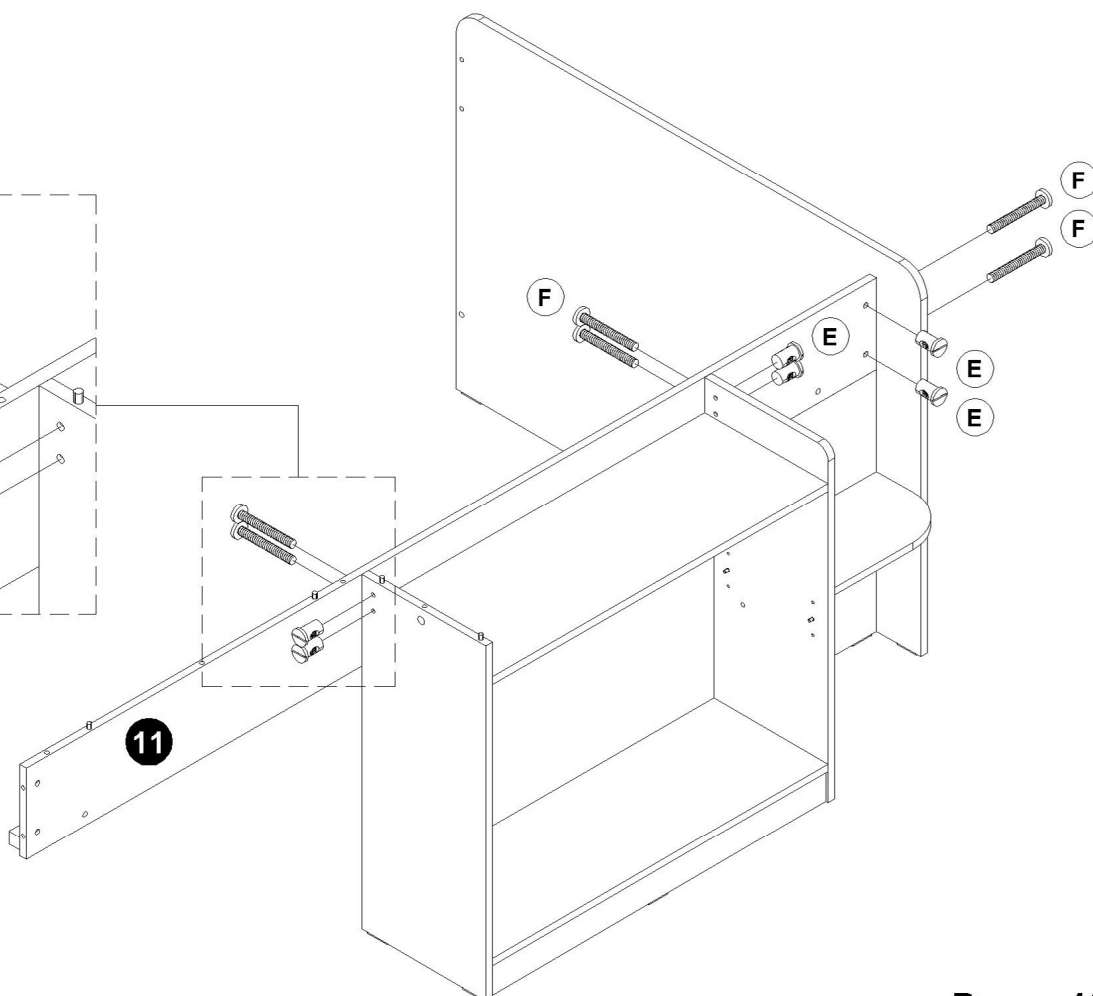
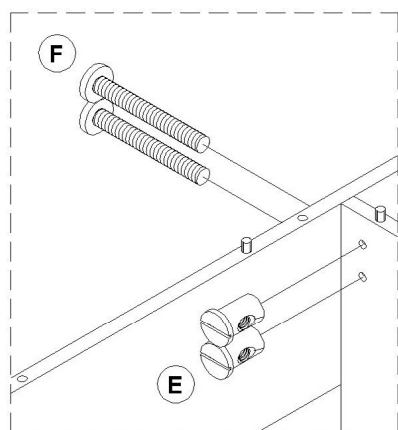

21



B x 1

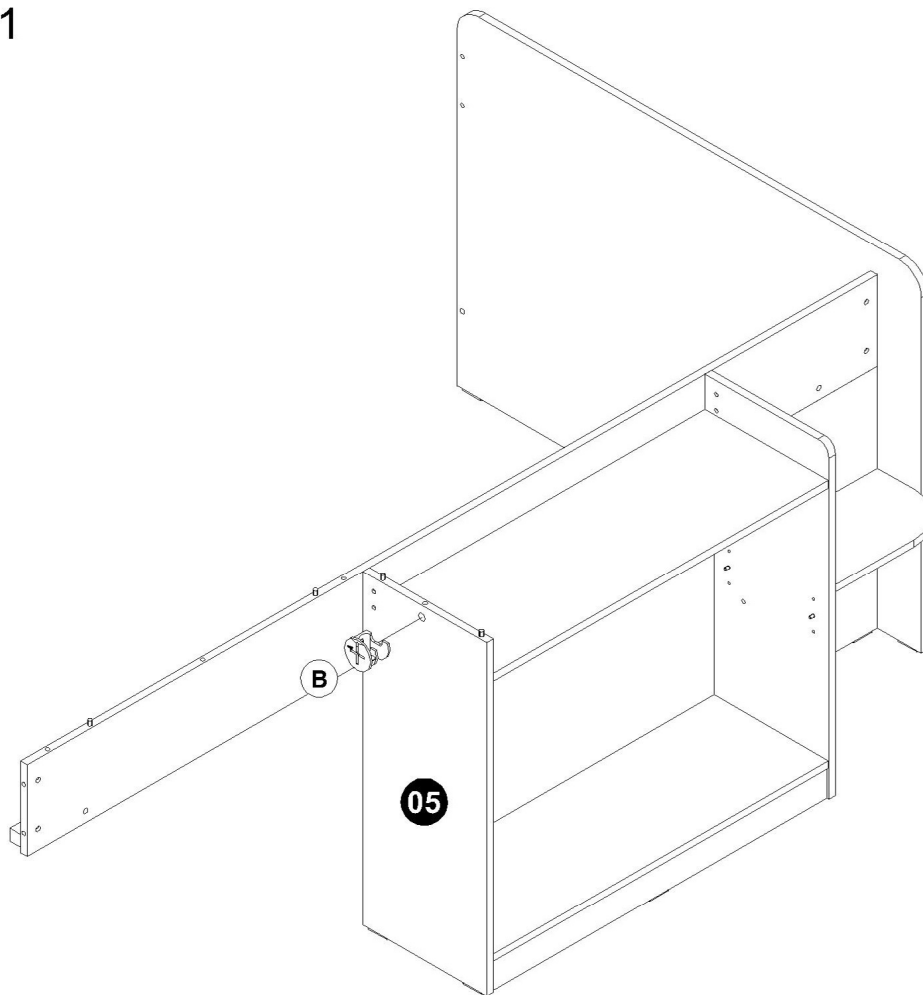

22

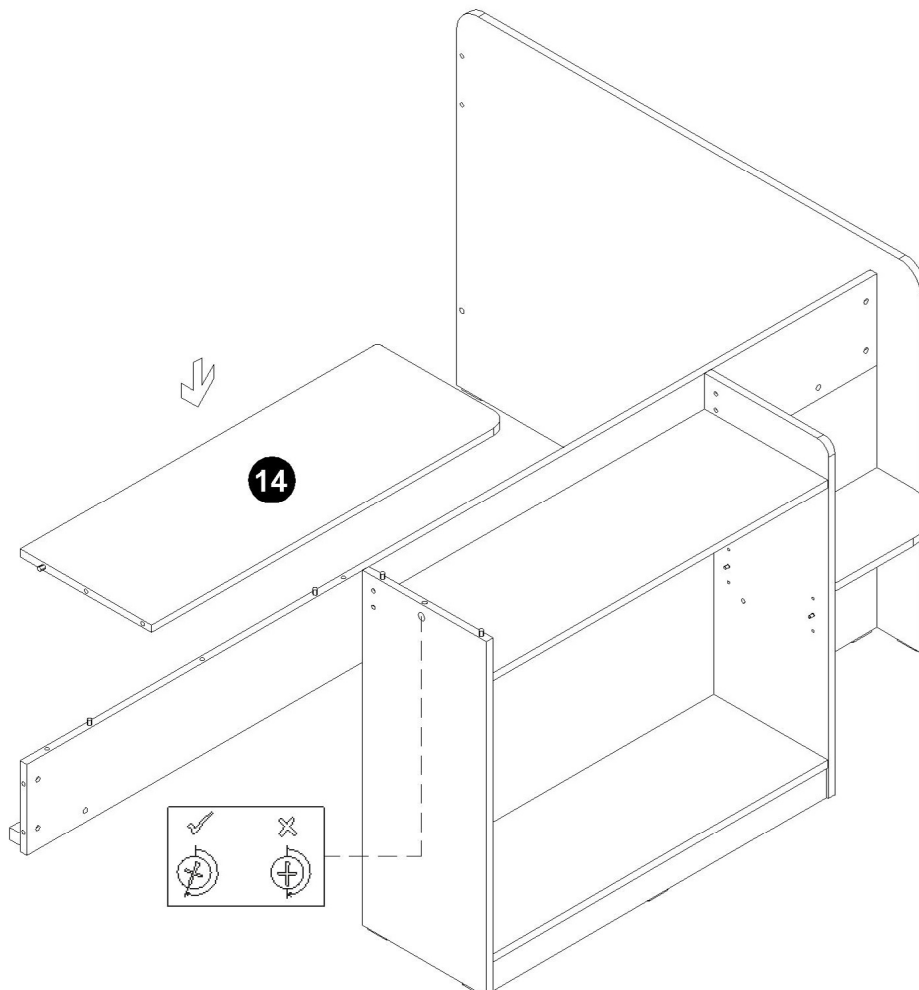

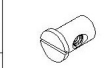
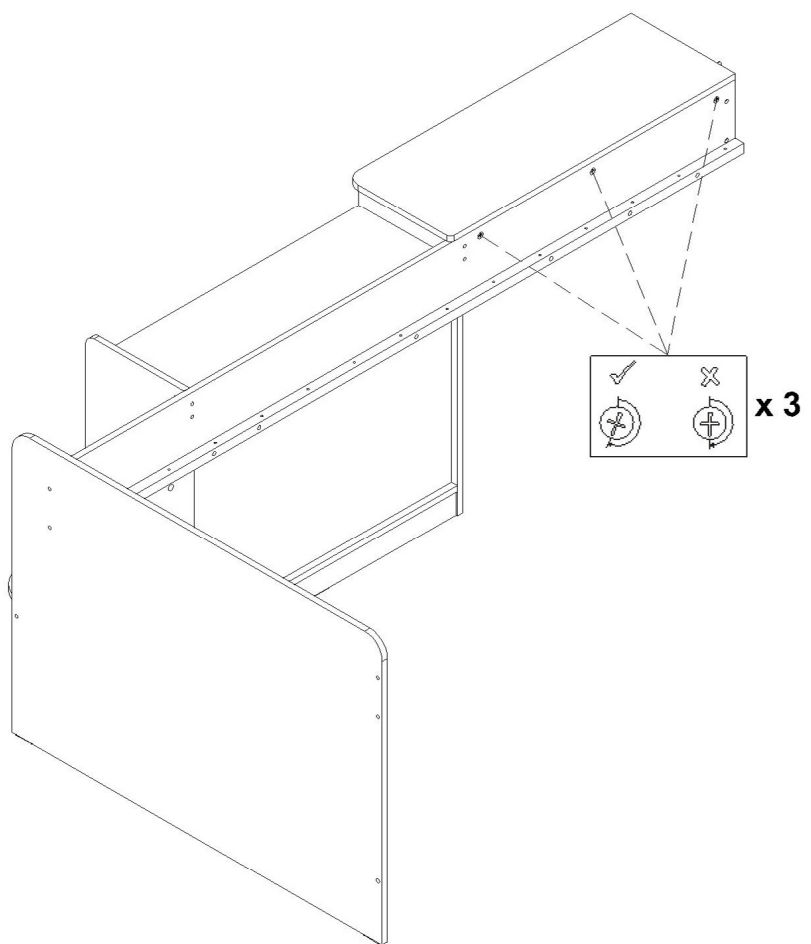

E x 2

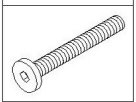

F x 2

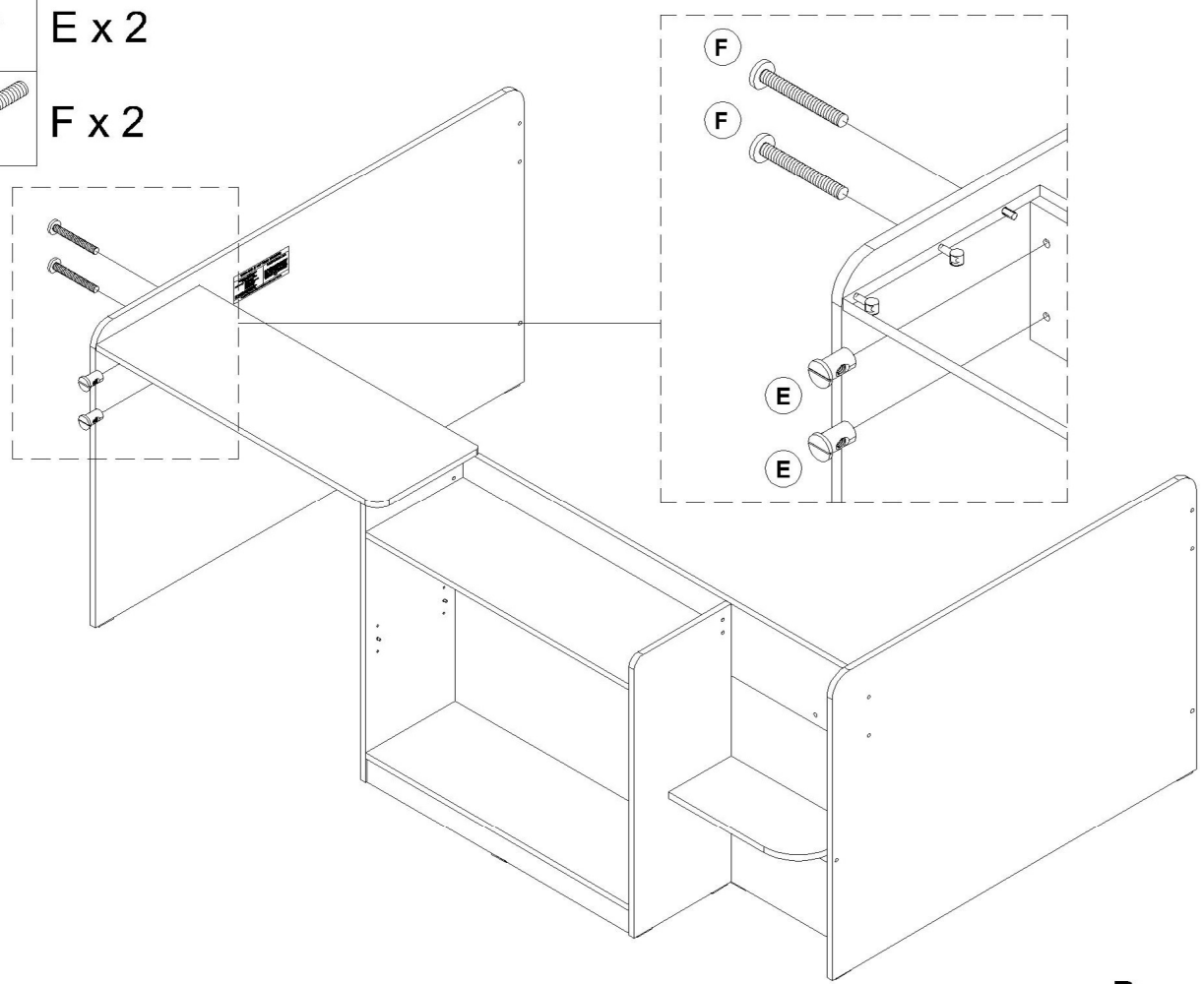

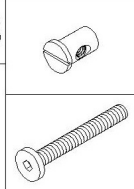
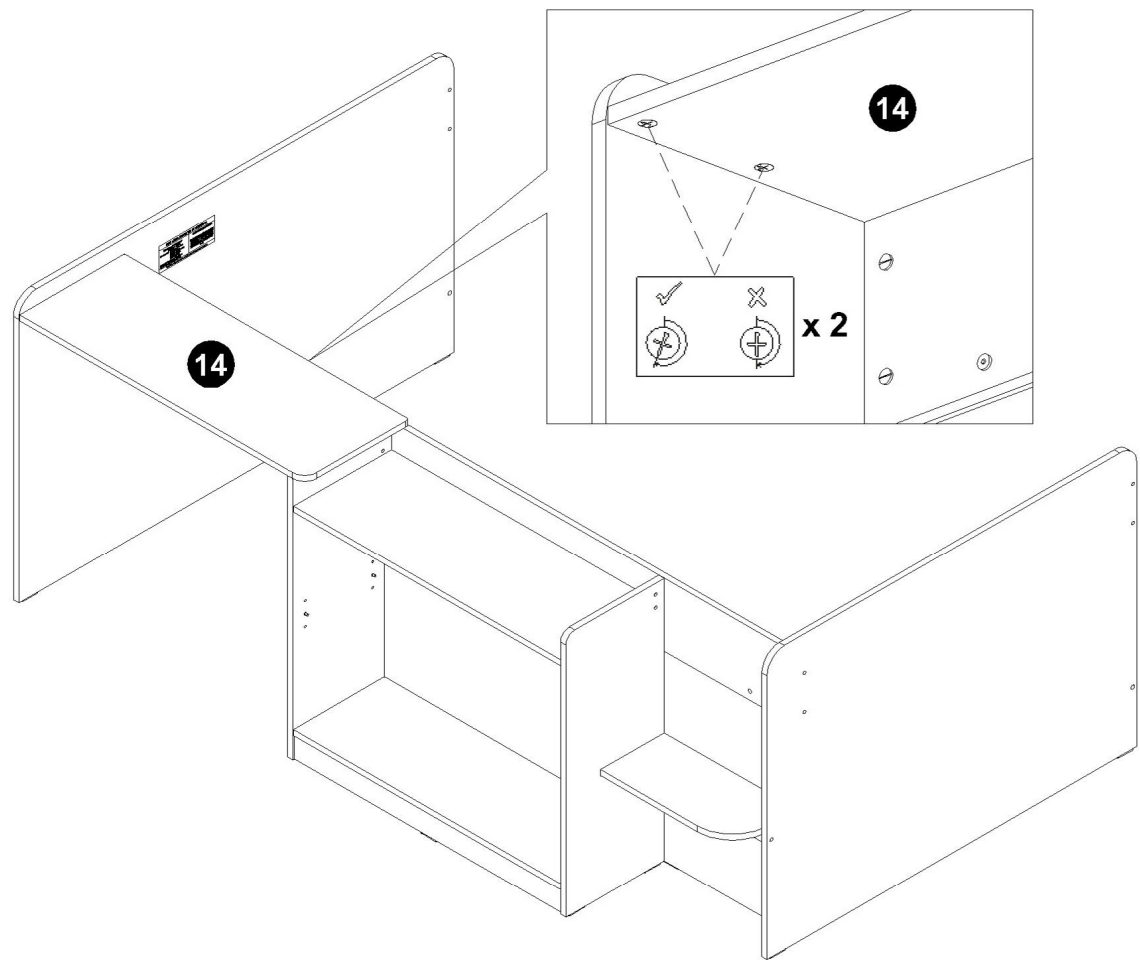

**E x 4**

**F x 4**

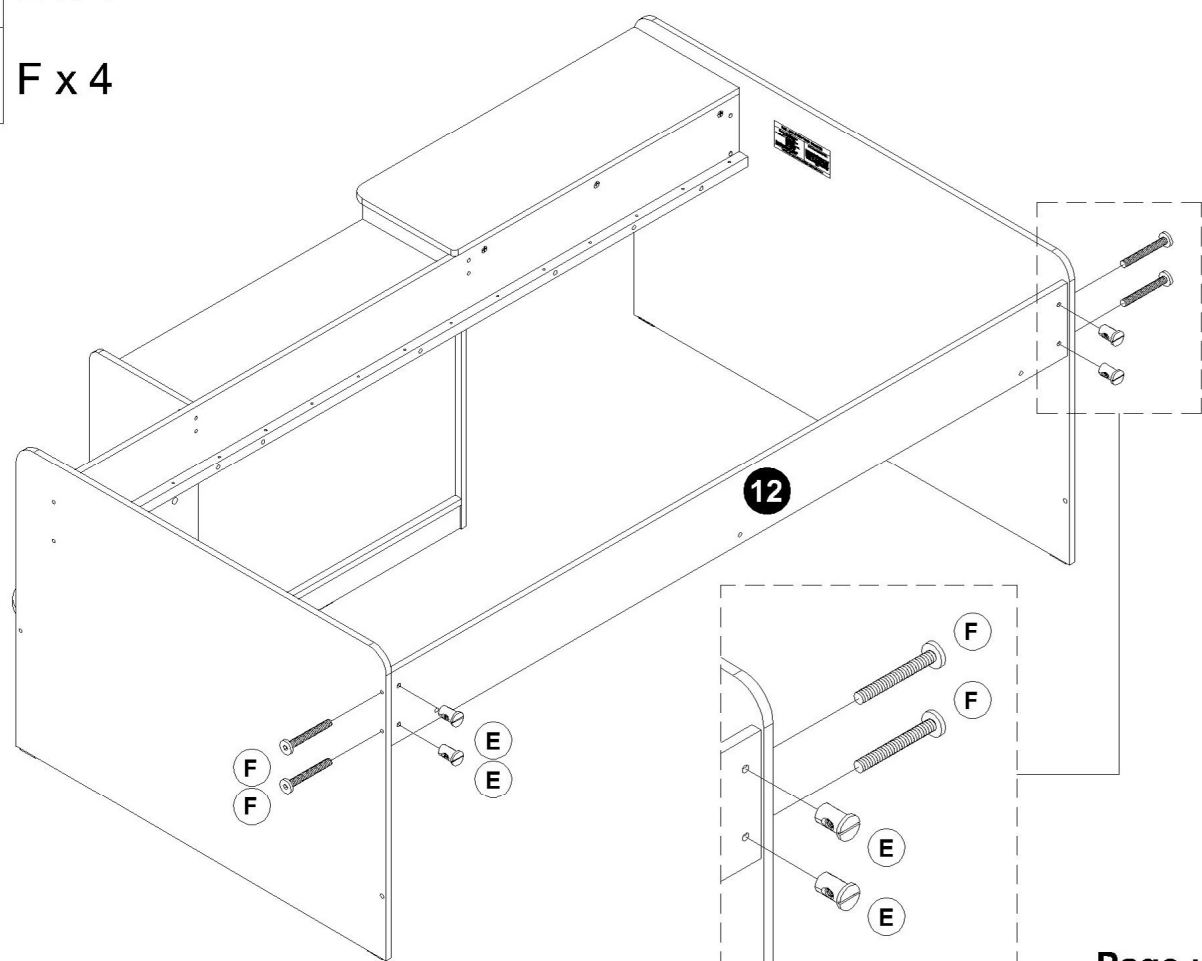

27



J x 4



K x 2

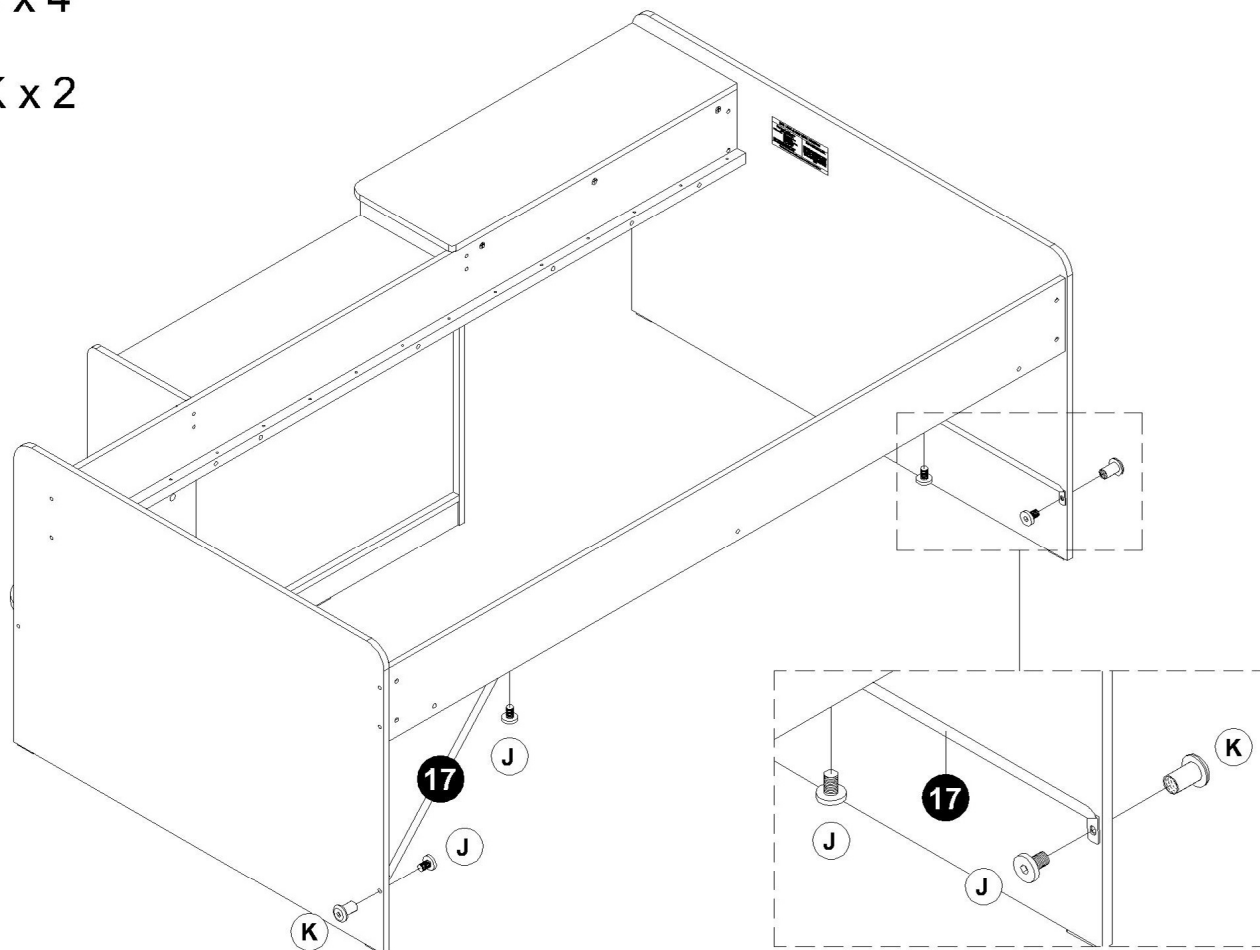

28



H x 30

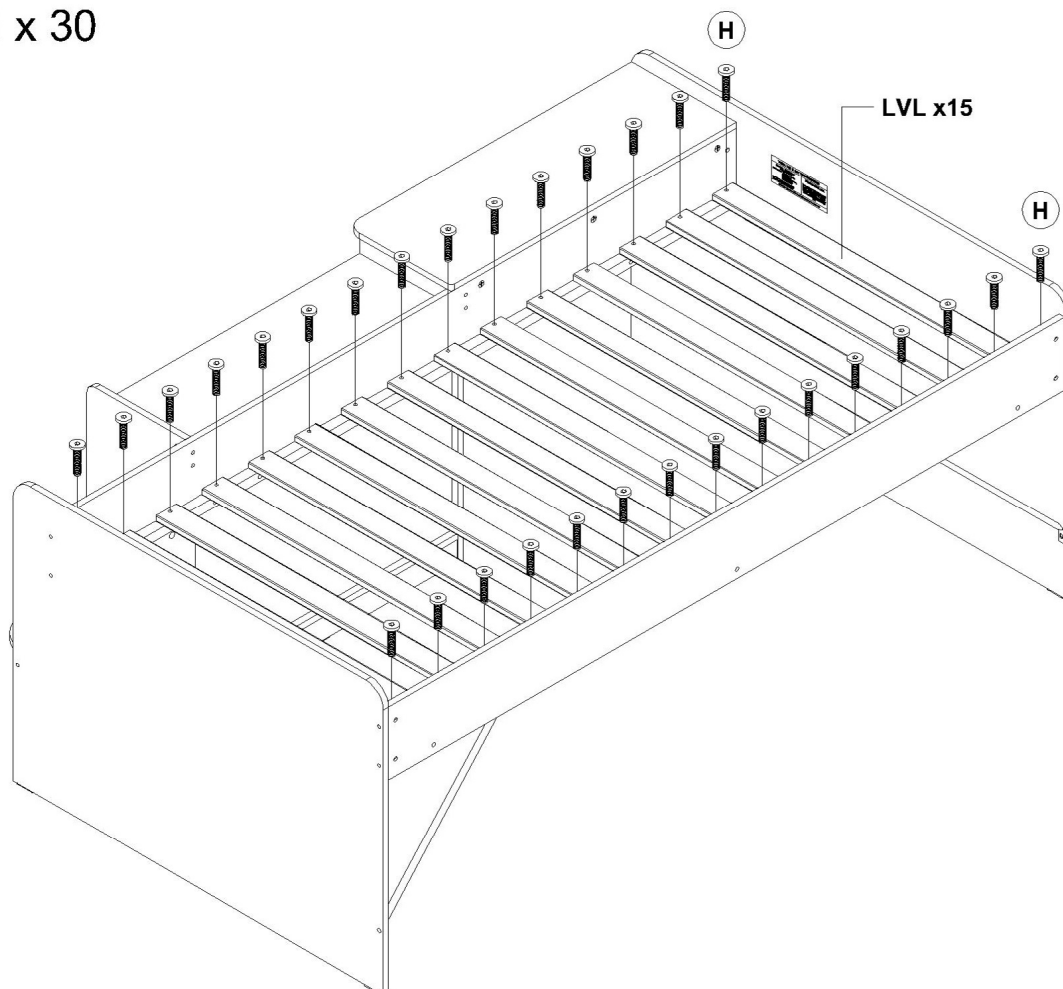

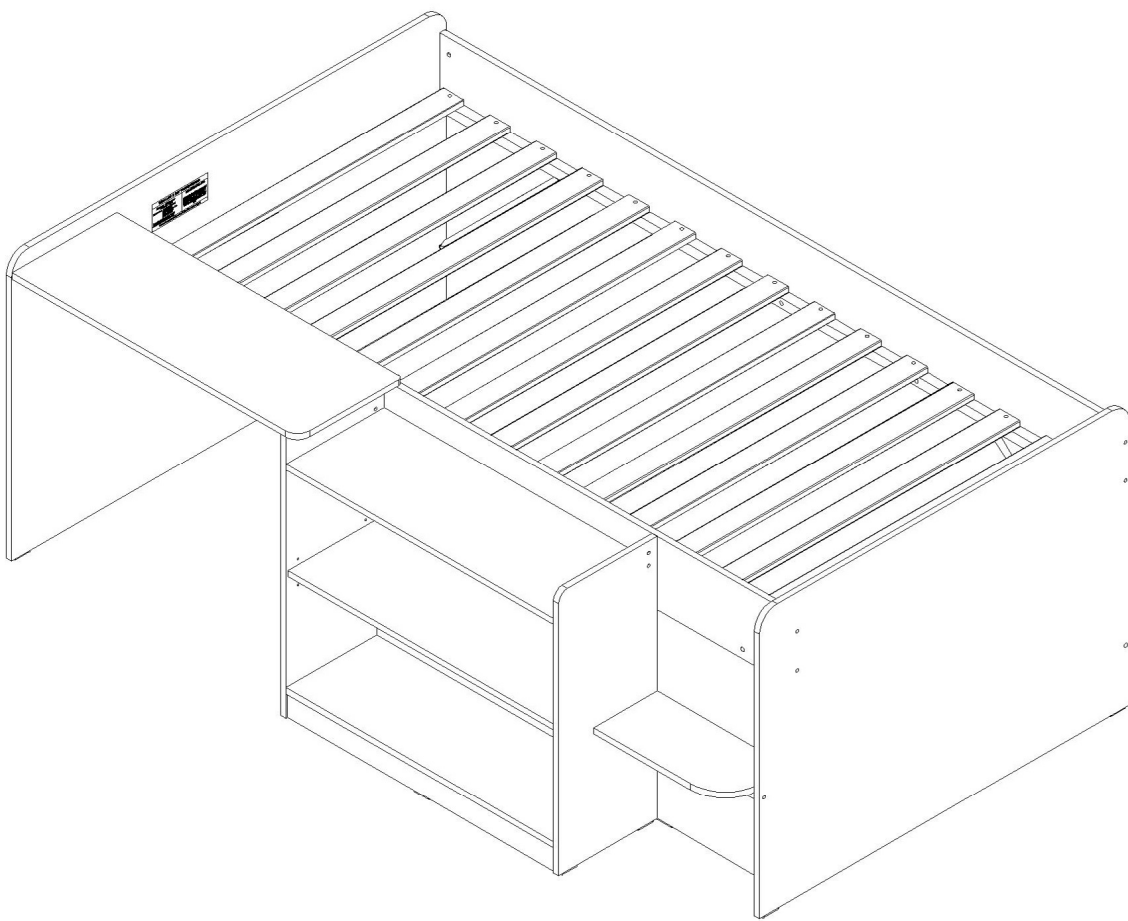
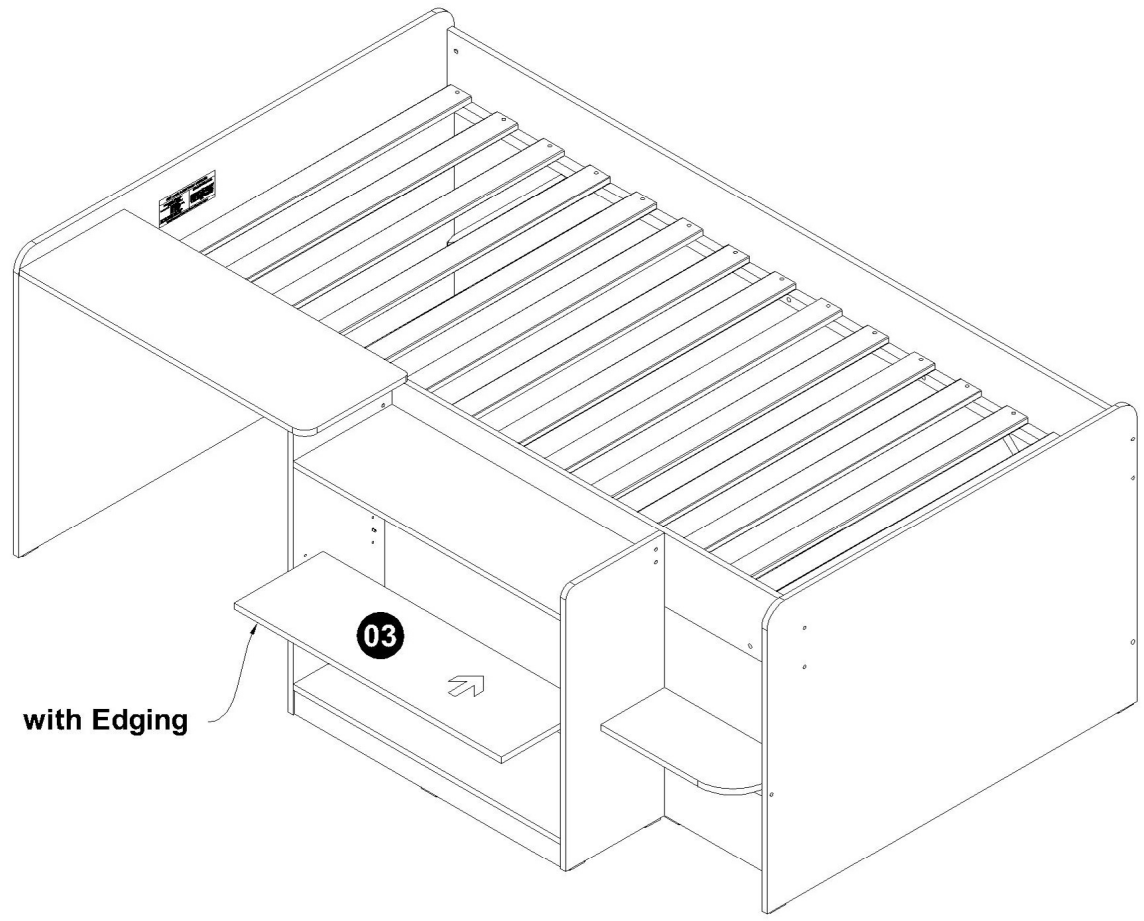



# **General Care**

Wipe clean with a slightly damp soft cloth.

Avoid the use of all household cleaners and abrasives.

When moving your furniture, carefully lift into place. Never drag or push the pieces across the floor as this will cause damage to the joints and could result in failure to the product that will invalidate the warranty.

# **Recommendations**

Periodical re-tightening of fixings.

# **Warning**

This unit is heavy. Please use an assistant when lifting.

# **Notes**

We've tried to make this piece of furniture as easy to assemble as possible. In the unlikely event that you have problems putting it together or have damaged or missing pieces, please contact our customer services on 01623 727374